

Llangollen Pavilion Technical Pack

This pack details our capacities, technical facilities, services and the requirements when hiring the venue.

Production

A full performance production service is available. We will be pleased to provide advice or assistance in designing seat layout, organising ticket sales, advertising, merchandising, stage-management and set design. Our trained staff provide both technical and front of house support and are happy to help both you and your audience.

The venue has full staging facilities with ample dressing room space for a full company of players including large rear hall, male and female changing rooms with integrated showers and toilets, green room, and additional dressing space if required. The versatility of our stage construction allows us to tailor the performance area to your own specific needs.

Comprehensive lighting and sound control solutions complete the package and ensure our reputation as a premier venue.

Marketing

We can assist your marketing team in planning and implementing your marketing strategies. We can offer support in terms of the following:

- Listings in Pavilion Brochure
- Inclusion in Pavilion Website, Denbighshire Website & Wales Tourist Board Website
- Opportunity to advertise in Pavilion Season Brochure
- Distribution of Flyers and Posters
- Local Press Campaigns – Adverts, Press Releases
- Direct Mail Campaigns and e-marketing
- Computerised Ticketing solutions
- On-line ticket sales through Instant Ticket Seller

Services

The Pavilion team will work closely with you to ensure your event runs smoothly, through in-house provision, advice and support. We will discuss the Hirer's responsibilities in terms of Licensing, Health and Safety provision, Insurance Cover and Security and can negotiate competitive prices on your behalf for all services required.

Hiring the Facilities



pafiliwn **Ilangollen** pavilion

COMEDY | CONCERTS | CONFERENCES | EVENTS

Hire fees for the Pavilion are negotiated with individual organisations to suit their requirements fulfilling a bespoke package for each event.

The responsibilities for Hirers, and the Pavilion services offered, are detailed below.

Hirer's Responsibility include

- Advertising and Publicity
- Catering (performers & audience) attracting catering Rights Fee
- Car Park Stewards
- Event Insurance
- Equipment required
- First Aid
- Riders (Choir/Band/Performers)
- Security and Stewarding
- Signs
- Stage Set, Sound & Lighting
- Tickets, Merchandise & Sales
- Performing Rights Society costs
- Event Risk Assessment

The Pavilion can assist with every item, depending on your needs.

Pavilion's Responsibility include

- Bar Contractors and additional marquees
- Car Parks
- Toilets/sanitary provisions
- Fire Extinguishers
- Licensing (Liquor, Public Entertainment, Theatre, Cinema)
- Refuse & Litter Collection
- Communication with emergency bodies, neighbours, fire officer and Health and Safety Officers, Environmental Health as required.

Planning Considerations

- Meetings to discuss Risk Assessment, H&S Issues and other costs.
- Meeting with Emergency Services
- Schedule of events / preparation / set up / breakdown
- Curfew 10.30pm for Arena events
- No pyrotechnics or smoke machines permitted
- No Smoking Policy in existence.

pafiliwn **llangollen** pavilion

COMEDY | CONCERTS | CONFERENCES | EVENTS

Facilities

The facilities available on site are split into three sections: the site itself, the Core Building and the Arena. Below are details for each section of the Pavilion.

Site (capacity 9,800 including premises)

Site Measurements	19.266 acres
Area 1 – Pavilion and Coach Park	8.952 acres
Area 2 – Overflow Parking	4.012 acres
Area 3 – Overflow Parking (not school time)	6.302 acres

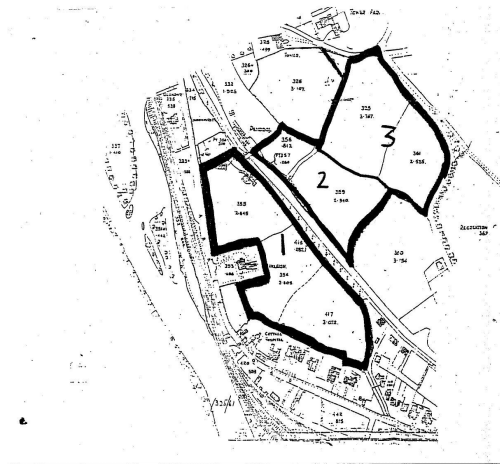



pafiliwn **llangollen** pavilion

COMEDY | CONCERTS | CONFERENCES | EVENTS

Arena

Seating Capacity	Permanent Extended (summer)	1400 (standing 2000) 4500 (standing 6000)
Suggested Uses:	Performances, conferences, fairs, product launches	
Floor:	Solid permanent arena, grass extension	
Power:	See separate sheet	
Access:	For performers/delegates via core building For loading/unloading direct access to outside.	
Size:	Permanent solid Floor area approx 1,325 sqm Semi-circular with high arched room	
Stage:	10.8m deep, 40.08m at the widest point 31.2m wide between steps leading down to seated area.	
Acoustics:	As part of the 2010 refurbishment the acoustics in the Arena have been improved	
Toilets:	External toilet blocks.	
Heating:	No permanent heating	

pafiliwn **llangollen** pavilion

COMEDY | CONCERTS | CONFERENCES | EVENTS

MAIN ARENA PERMANENT AUDITORIUM

MAIN ARENA EXTENDED AUDITORIUM

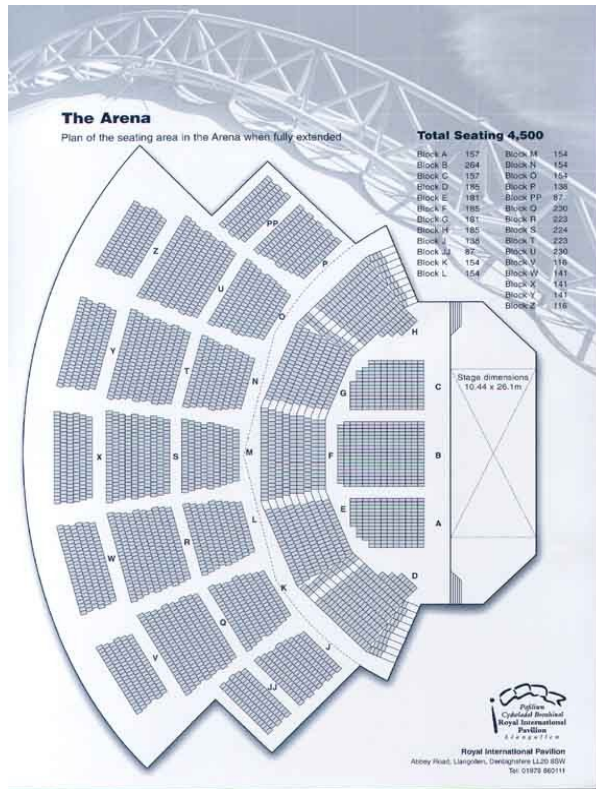
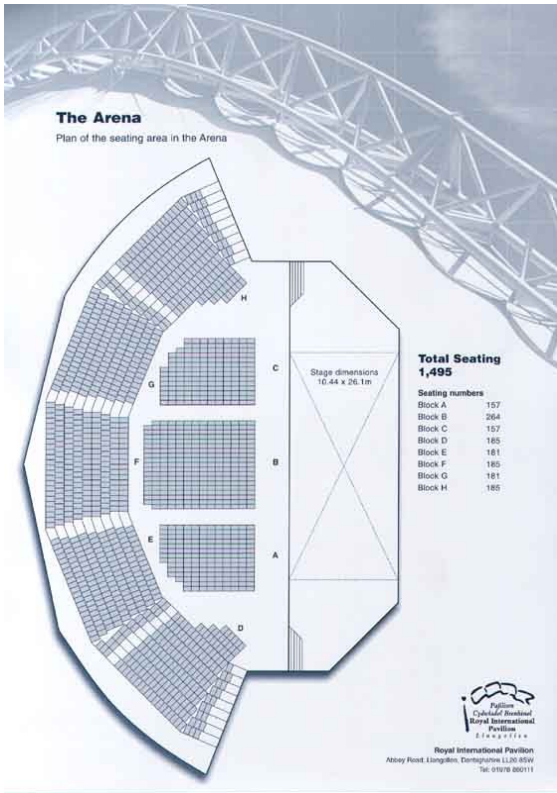

pafiliwn **llangollen** pavilion

COMEDY | CONCERTS | CONFERENCES | EVENTS

GROUND FLOOR PLAN

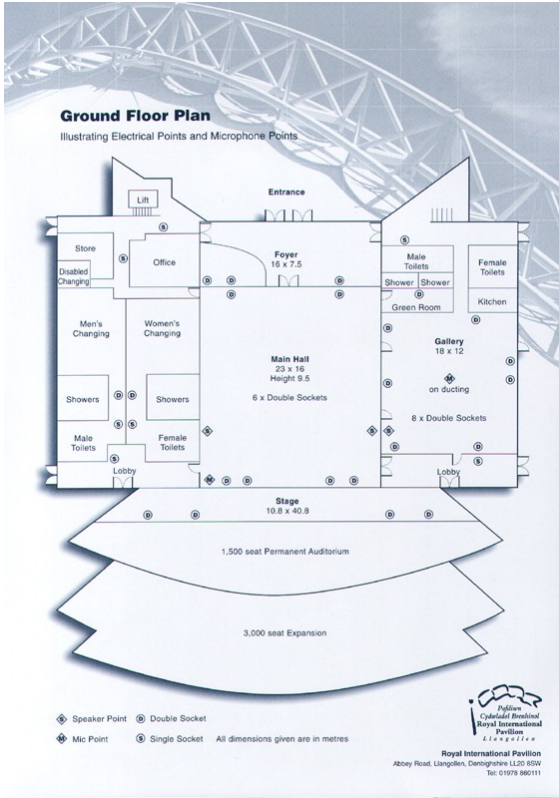

FIRST FLOOR PLAN

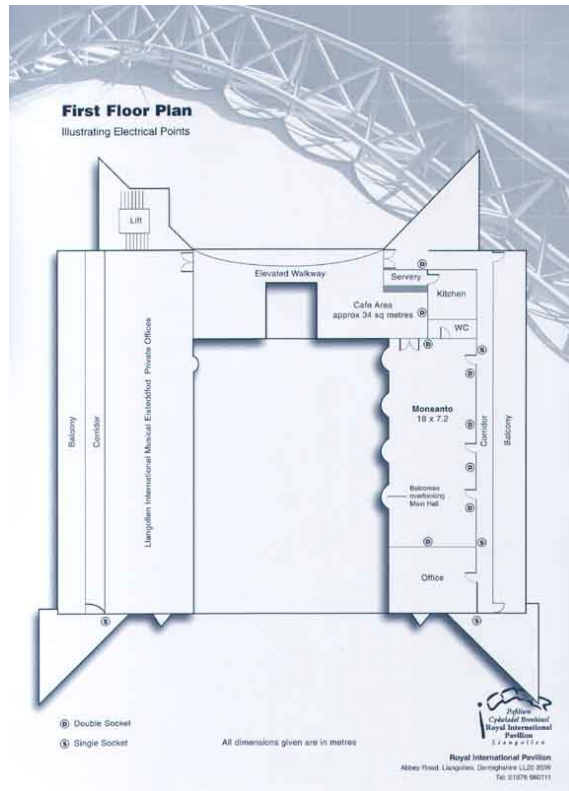

Core Building

Ground Floor Specifications

Main Hall

Capacity:	454 theatre style / 200 cabaret / 500 standing
Suggested Uses:	Backstage area for Arena Events Concerts, conferences, dances, parties, flower shows, fairs, competitions
Floor:	Carpeted
Equipment:	Gantry mounted projector and 4m screen
Power:	10 double 13 amp sockets, three phase available
Access:	Via double doors 1.42m wide x 2.02m high Via raised roller shutters 1,8m wide x 2.70m high
Telephone:	In adjacent rooms
Size:	9.5m high x 23m x 16m
Acoustics:	As part of the 2010 refurbishment the acoustics in the Arena have been improved
Permanent Dance Floor :	9.5 m x 16m (covered and protected when not in use)
Divider Curtain at 7.5m from the far end of the hall creates a smaller main hall (200-250 seated) and a studio theatre black box (upto 100 seated)	

Gallery

Seating Capacity	140 theatre style (40 board room)
Suggested Uses:	Art Exhibitions, Studio Theatre, Cinema, Private Room
Floor:	Carpeted
Power:	8 double 13 amp sockets
Access:	Via 2 x single doors 0.8m x 2.02m to Main Hall Via 1 x single Door to inner lobby nr green room & kitchen Via 1 x single door 0.8m x 2.02m external Via 1 x single door 0.8m x 2.02m to stage side lobby



pafiliwn **Ilangollen** pavilion

COMEDY | CONCERTS | CONFERENCES | EVENTS

External:	Paved terrace accessed by single door
Telephone:	In adjacent rooms
Size	18m x 12 m

Ground Floor Kitchen

The kitchen is a professional catering kitchen for 225 covers.

Floor	Vinyl
Access	Swing Door + servery hatch

Changing Rooms

Interjoining male and female changing rooms with toilet facilities and a total of 18 showers.

Foyer

Suggested Uses:	Reception, Foyer, Display, Exhibitions
Floor:	Carpeted
Power:	2 x double domestic power sockets
Equipment:	52" LED TV with PC Unit attached. HDMI connection & freeview
Telephone:	1
Size:	16m x 7.5m
Access:	1 x double Doors 1.42m wide x 2.02m high to Main Hall 2 x double Doors 1.42m wide x 2.02m External 2 x double Doors 1.42m wide x 2.02m to ground floor side lobbies.
Adjacent:	Male & Female toilet blocks Lobby with Lift to First Floor

First Floor Specifications



pafiliwn **Ilangollen** pavilion

COMEDY | CONCERTS | CONFERENCES | EVENTS

Monsanto Suite

Seating Capacity	100 theatre style, 40 boardroom
Divider:	The room is dividable by a high quality wooden screen into two breakout rooms rooms
Suggested Uses:	Receptions, meetings, conferences, café, parties, sponsor suite, training room
Floor:	Carpeted
Equipment:	Data screen
Access:	Stairs and lift to 1 st floor 2 x double doors 1.42m x 2.02m to 1st floor lobby 1 x double door 1.42m x 2.02m to Monsanto Suite Serving and Single Door to First Floor Kitchen Balcony x 4 overlooking Main Hall
Telephone:	1 point
Size:	18m x 7.2m
Adjacent:	Private toilet, elevated bar deck and first floor kitchen
Technical Support:	Presentation unit, TV, video, Lectern.

First Floor Kitchen

Suggested Uses:	Light Food Preparation and Serving
Floor	Vinyl
Power	7 double domestic power points
Services	Dishwasher, fridge, microwave, sink, crockery
Access	Single door
Telephone	None
Size	4m x 3.5m



pafiliwn **Ilangollen** pavilion
COMEDY | CONCERTS | CONFERENCES | EVENTS

Elevated Bar Deck

Capacity	60
Suggested Uses:	Receptions, sponsor suit, TV studio, buffet and drinks
Floor:	Laminate
Power:	6 double 13 amp sockets Track lighting
Access:	Stairs x 2 and lift to 1 st floor 2 x double doors 0.8m x 2.02m to corridor 1 x single door 0.8m x 2.02 to Elevated Bar Deck Full length sliding glass Doors overlooking Main Hall.
Telephone:	1 point
Size:	18m x 7.2m
Adjacent:	Private toilet, Monsanto Suite and first floor kitchen

Electrical Supply Specification

Main Hall (Lighting Cupboard)

- 3 Phase 32A 5 pin socket
- Hall stage lighting (isolator at high level, 3 phase 200A)
- Isolator feeds lighting room (84 channels of 2.5k dimming with 15A outlets)

Arena

- At high level Arena stage lighting isolator
- 3 phase 200A – currently being upgraded – details on request

Lighting Gantries

Main Hall

- 4 x lighting bars 12m long designed to lift a total of 500 Kg.
- Stage lighting Dimmers are located in a newly constructed dimmer room
- The main electrical supply with distribution board is restricted to 200amp TP.
- The dimming system of 3 x 24 way, 2.5 Kw and 2 x 6 way
- 2.5 Kw Strand Wall Racks. = 84 Dimmers.

Arena

- 6 x lighting bars 18.5m long designed to lift a total of 1000 Kg. (including truss weight truss = 300 Kg max pay load = 700Kg) = 1000Kg.
- Stage lighting Dimmers are located in a newly constructed dimmer room
- The main electrical supply with distribution board is restricted to 300amp TP.
- The dimmers comprise of 132 x 2.5 Kw Strand type hard wired Wall racks comprising of 5 x 24 way racks and 2 x 6 way racks.
- Also 60 x 2.5 Kw. (Non dim hot power) dimmer racks, comprising of Strand type hard wired Wall racks, 2 x 24 way and 2 x 6 way racks.

Technical Equipment Available in Core Building

Lighting Equipment

- Lanterns (all fitted with 15A connectors)
 - 4x Cantata Fresnel 1.2k (with barn doors)
 - 4x Cantata P.C. 1.2k (with barn doors)
 - 6x Selecon Rama Fresnel 1.2k (with barn doors)
 - 4x Selecon Rama P.C. 1.2k (with barn doors)
 - 6x ETC Source 4 26° Profile 575w
 - 4x ETC Source 4 15-30° Profile 750w
 - 2x ETC Source 4 25-50° Profile 750w
 - 10x Selecon Lui single cyc flood 1k
 - 18x long nose Par 64 1k (mixture of CP61 & 62)
 - 10x short nose Par 64 floor can (mixture of CP61 & 62)

- Intelligent Fixtures
 - 6x Martin Mac 250 Krypton moving head profile

- Dimming
 - 84 channels of 2.5k dimming with 15A outlets

- Control
 - 1x Strand Classic Palette 200 channel memory desk with TFT Monitor

- Cable
 - 2x 20m socapex with breakouts
 - Large selection of 5m, 10m and 20m 15A extension leads
 - 20x 400mm 15A → 16A convertor leads

- Other
 - Selection of gels and gobos



pafiliwn **Ilangollen** pavilion

COMEDY | CONCERTS | CONFERENCES | EVENTS

Rigging and Patching

- 4x 12m long internally wired bars: 3 located above stage and 1 front of house
 - raised and lowered using electric hoists.
 - each has 12x 15A dimmer circuits, 1x DMX outlet and 1x 240V power supply
- 2x 5m long fixed internally wired bars: located on side wall each side of stage
 - each has 5x 15A dimmer circuits, 1x DMX outlet and 1x 240V power supply
- 2x approx. 15m long fixed internally wired bars: located on side wall front of house
 - each has 8x 15A dimmer circuits, 1x DMX outlet and 1x 240V power supply
- Ground level circuits: located on side wall each side of stage
 - each side has 4x15A dimmer circuits, 1x DMX circuit and 2x 240V power supply
- 1x 12m long unwired bar: located upstage
- Power 1x 32A 3 phase outlet in dimmer room / 4x 13A outlets on stage.

Sound Equipment

- Microphones
 - 4x Shure SM58
 - 2x Shure Beta 57
 - 2x AKG C1000
 - 4x SM58 clone
 - 4x Pro Signal Boundary mic
 - 2x CPC gun mic
 - 2x Behringer C1
 - 2x Sennheiser e100 radio receivers
 - 1x Sennheiser MKE2 (lav)
 - 10x Behringer Ultra DI box
 - 1x Superlux Drum mic set (1x kick, 1x snare, 2x tom, 2x overhead)
- Speakers
 - 4x Bose 802 (with controller)
 - 2x DAS DS15
 - 4x Studiospares Auditorium K215MT 400w monitors
 - 2x Studiospares Auditorium K118SB 600w subs
- Mixing Desks
 - Soundcraft Delta 16Ch 4Grp 4Aux
 - Soundcraft Spirit Notepad 6Ch
 - Phonic Power Pod 107 400W mixer amp 7Ch



pafiliwn **Ilangollen** pavilion

COMEDY | CONCERTS | CONFERENCES | EVENTS

- Soundlab 100W mixer amp 4Ch
- Amp rack
 - 4x Yamaha P2200 400W
 - 4x Yamaha P7000 1000W
 - 2x DBX dual 15 band graphic equalisers
 - 1x Bose 802 controller
 - 1x Behringer DCX speaker management system
- Cable
 - Multicore 16way 4return 50m
 - Various XLR cables
- Other
 - Various mic stands
 - 4x Speaker stand
 - Outboard graphic equaliser
 - Outboard CD player

Other

- a. Rear of stage has a dark green drape (6m height). There are no front or wing tabs.
- b. Stage is constructed using the Vario Stage unit system (2m x 1m units) and can be set at 0.4, 0.6, or 0.8m height (maximum units available 44).
- c. Seating within the Main Hall is flexible, though not tiered or raked.
- d. Access to the Main Hall is at ground floor level, accessible via main entrance doors to the premises (measuring 198cm high x 132 cm width). There is no lifting equipment available from floor level to stage level for equipment.
- e. Talloscope available (model 518) max height 7.9m.
- f. Skyjack 3220 scissor lift
 - Battery Powered (Chargeable from a 13amp 240v supply).
 - Working Height 8.1m
 - Platform Height 6.1m
 - Width 0.84 m
 - Length 2.32 m
 - Cage Capacity 408kg
 - Platform dimension: 0.71x2.13m



pafiliwn **llangollen** pavilion

COMEDY | CONCERTS | CONFERENCES | EVENTS

- g. The Company must confirm all technical requirements four weeks in advance of the performance with the Technical Team at the Pavilion in writing. E-mail address: geoff@royal-pavilion.co.uk
- h. Any electrical portable appliance equipment brought into the Pavilion must have a current P A T certificate.

External Specifications & Parking

Location

- Llangollen is situated near the Welsh/Cheshire/Shropshire Border and is only a one hour drive from Liverpool and Manchester Airport.
- Excellent Road networks via M6 / M54 to A5, or M56 /M53 to A489 / A525
- Nearest Rail Stations Ruabon/ Chirk (6 miles)
- Closest large towns – Wrexham 12 miles, Chester/Shrewsbury 25 miles.

Festival Site

- On site parking – 160 cars
- Designated Disabled Car Parking area
- Power: 8 External LX boxes on Site each with 6 x 16 amp, 1 x 32 amp 3 Phase
- Water: 3 External taps
- Uses: Trade Pitches, family fun days, festivals, launch pad balloons, outdoor arena displays e.g. motorcycle stunts, dog handling, Pit Stop HQ for Rallies.

Coach Park

Parking for 20 coaches
Or parking for 160 cars

Overflow/festival parking

Area 1 – parking for 400 cars
Area 2 - (available out of school hours) parking for 800 cars